



45 Canterbury Road

Willesborough, TN24 0BL

Price £225,000

Offered for sale with no onward chain is this end of terrace home in the popular Willesborough area.

The property would benefit from some modernisation and comprises a sitting/dining room, kitchen, ground floor bathroom and two bedrooms. To the rear is a lengthy garden along with off road parking, double glazing and gas central heating are also installed.

- END OF TERRACE HOUSE
- TWO BEDROOMS
- DRIVEWAY TO REAR
- GENEROUS GARDEN
- MODERNISATION REQUIRED
- DOUBLE GLAZING
- GAS CENTRAL HEATING
- NO ONWARD CHAIN

Viewing

Please contact our Ashford Office on 01233 646411 if you wish to arrange a viewing appointment for this property or require further information.

Floor Plan

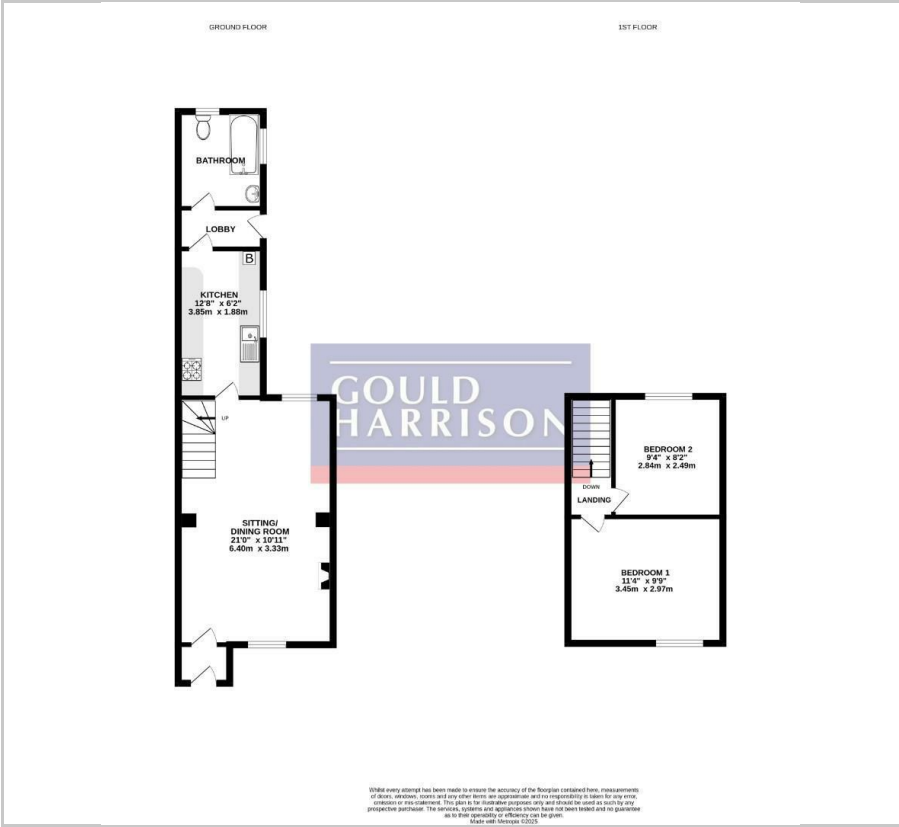

Area Map



Energy Efficiency Graph

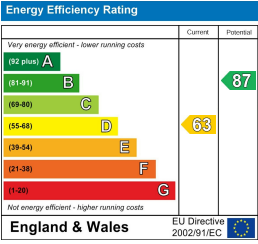

These particulars, whilst believed to be accurate are set out as a general outline only for guidance and do not constitute any part of an offer or contract. Intending purchasers should not rely on them as statements of representation of fact, but must satisfy themselves by inspection or otherwise as to their accuracy. No person in this firm's employment has the authority to make or give any representation or warranty in respect of the property.